



COYOTE® Dome, In-Line RUNT, Taut and Terminal Closure Grommets

Be sure to read and completely understand this procedure before applying product. Be sure to select the proper size PREFORMED™ product before application.

NOMENCLATURE

1. End Plate Grommet
2. Plugs (one provided for each grommet entry)
3. Measure Tape
4. Silicone Lubricant (2)
5. Glove (1)

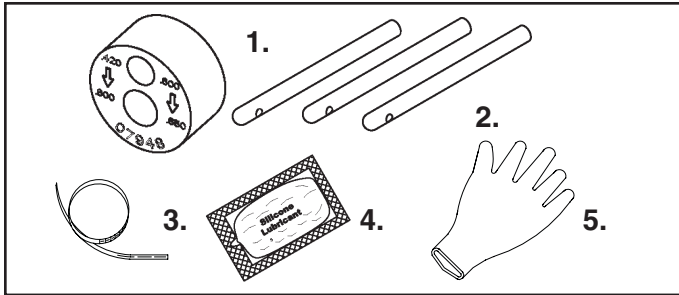

Step #1 Measure cable to determine diameter and hole location to use in grommet.

Step #2 If using cut cable, insert cable through grommet. If your application requires express cables, see Step 3 for grommet slitting procedure.

COYOTE Grommet Chart For use in COYOTE Dome, In-Line RUNT, Taut & Terminal Closures			
PLP Catalog Number	Cable Range Inches (mm)	Description	Splitting Location
8003701	.42 - .85 (10.7 - 21.6 mm) .60 - .85 (15.2 - 21.6)	1-entry grommet	
8003691	.42 - .60 (10.7 - 15.2 mm)	1-entry grommet	
8003692	.60 - .85 (15.2 - 21.6 mm)	1-entry grommet	
8003693	.85 - 1.0 (21.6 - 25.4 mm)	1-entry grommet	
8003694	1.0 - 1.25 (25.4 - 31.6 mm)	1-entry grommet	
8003663	.42 - .60 (10.7 - 15.2 mm)	2-entry grommet	
8003664	.30 - .43 (7.6 - 10.9 mm)	4-entry grommet	
8003665	.125 - .25 (3.2 - 6.4 mm) and flat drop	6-entry grommet	
8003676	.42 - .60 (10.7 - 15.2 mm) .125 - .25 (3.2 - 6.4 mm) and flat drop	7-entry grommet	
8003677	.125 - .25 (3.2 - 6.4 mm) and flat drop	8-entry grommet	
8003796	Flat Drop Only	12-entry grommet	

NOTE: Grommet Kit contains (1) Grommet, (1) Cable Measure Tape, (2) Silicone Lubricant Packs, (1) Set of Plugs, (1) Glove

Step #3 Grommet Preparation

Select the entry hole(s) to be used in the grommet and pierce the thin layer of material covering the hole(s) on the outside surface.

Grommet Slitting Procedure for ExpressCables - Lay grommet on a stable flat surface. Position utility knife with the cutting edge against the top surface and cut through grommet. Consult grommet chart on page 1 for slitting locations of all grommets.

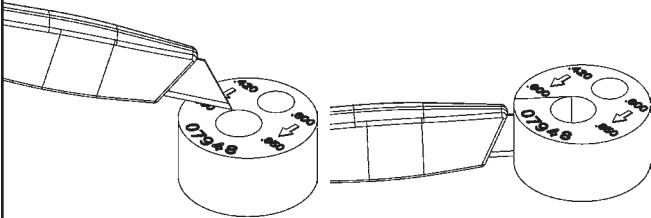

PLP Tip: Use a pen to sketch slitting lines on top surface of grommet prior to cutting.

Step #4 Grommet Installation

Apply silicone lubricant to outside surface of grommet. Orient grommet so grommet arrows are pointing downward as shown.

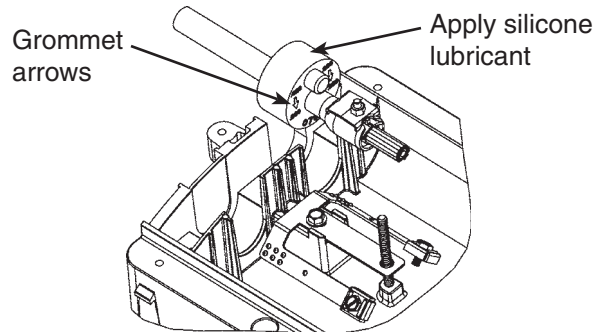

Step #5 Future Entry

Loosen bolts on End Plate cap.

Remove the plug from the grommet entry hole selected for the future cable entry.

Carefully pierce the thin layer of material on the outside surface of the grommet and push the cable through the grommet.

Retighten bolts on End Plate Cap.

SAFETY CONSIDERATIONS

This application procedure is not intended to supersede any company construction or safety standards. This procedure is offered only to illustrate safe application for the individual. **FAILURE TO FOLLOW THESE PROCEDURES MAY RESULT IN PERSONAL INJURY OR DEATH.**

Do not modify this product under any circumstances.

This product is intended for use by trained technicians only. **This product should not be used by anyone who is not familiar with, and not trained to use it.**

When working in the area of energized lines, extra care should be taken to prevent accidental electrical contact.

For proper performance and personal safety, be sure to select the proper size PREFORMED™ product before application.

PREFORMED products are precision devices. To insure proper performance, they should be stored in cartons under cover and handled carefully.



PREFORMED LINE PRODUCTS

P.O. Box 91129, Cleveland, Ohio 44101 • 440.461.5200 • www.preformed.com • e-mail: inquiries@preformed.com

SP2981-3